



AVAILABLE

MULTI-USE INDUSTRIAL RETAIL OFFICE

6841-7067 MICHIGAN RD.
INDIANAPOLIS, IN 46268
MARION COUNTY

1009 PARKING SPACES AVAILABLE
ZONING COMMERCIAL C-4
SUITE 6901

PROPERTY HIGHLIGHTS

±126,700 SF DIVISIBLE BUILDING AVAILABLE
BUILD TO SUIT OPPORTUNITY
16.04 ACRE SITE
20' CLEAR HEIGHT
ESFR SPRINKLER SYSTEM
4 DOCKS
5 DRIVE INS
24,829 VEHICLES PER DAY/MICHIGAN ROAD
OUTLOT BUILDING AND INLINE SPACES AVAILABLE
ON-SITE SECURITY AND CAMERA SYSTEMS IN PLACE

DEMOGRAPHICS

	1mi	3mi	5mi
Avg. Household Income	56,799	77,836	90,701
Daytime Population	4,521	68,409	187,230
Households	4,951	32,761	85,054
Population	13,737	77,949	203,164

LEASE OUTLINE DRAWING

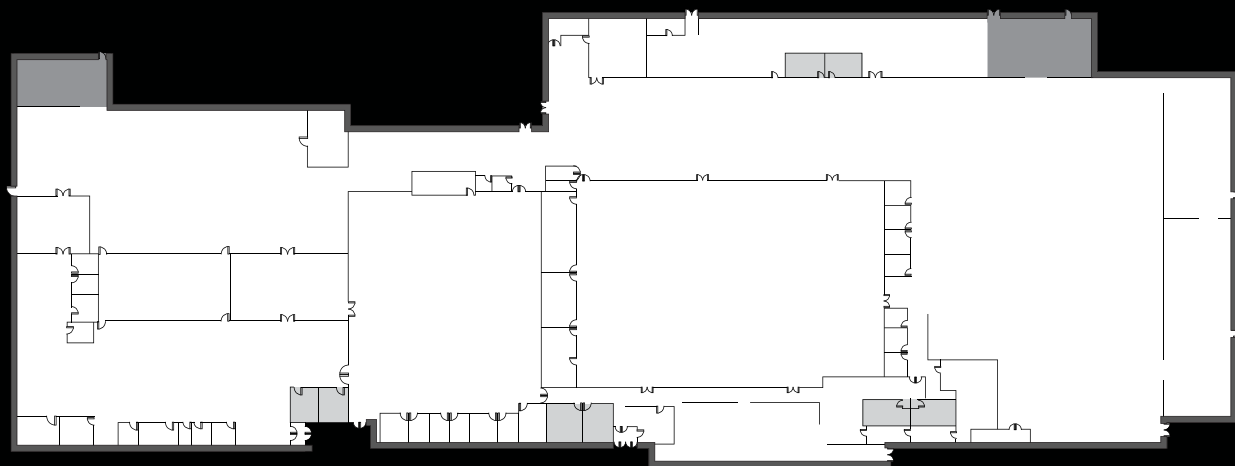

MAJOR RETAILERS

ESKENAZI HEALTH CENTER	CVS	SHELL
DAIRY QUEEN	KFC	TACO BELL
STARBUCKS	ALDI	OFFICE DEPOT
AUTOZONE AUTO PARTS	WALMART	URGENT CARE INDY
LOWES HOME IMPROVEMENT	COSTCO	CHICK-FIL-A
ASCENSION ST. VINCENT HOSPITAL		

THE MARKET

CROOKED CREEK, LOCATED NORTHWEST OF DOWNTOWN INDIANAPOLIS, IS A WELL-POPULATED NEIGHBORHOOD CONSISTING OF HOMES, COUNTRY CLUBS, RETAIL, CHURCHES, SCHOOLS AND PARKS.

NEIGHBORHOOD



BROADMOOR
COUNTRY CLUB



RH
COMING 2023

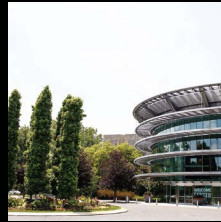

IMA AT NEWFIELDS



MERIDIAN HILLS
COUNTRY CLUB



HIGHLAND
COUNTRY CLUB



INDIANAPOLIS
AIRPORT



BUTLER
UNIVERSITY



DOWNTOWN
INDIANAPOLIS



INDIANAPOLIS
FEDEX HUB



GAINBRIDGE
FIELDHOUSE

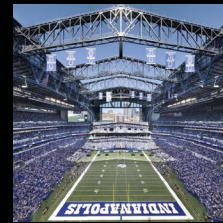

LUCAS OIL STADIUM



HOLLIDAY PARK



HIGHLANDGOLF CLUB



CHILDREN'S MUSEUM
OF INDIANAPOLIS



INDIANAPOLIS
PUBLIC LIBRARY



CARMEL, IN



BROAD RIPPLE, IN



MERIDIAN HILLS
COUNTRY CLUB



EAGLE CREEK PARK



ZIONSVILLE, IN



SPORTZONE INDY

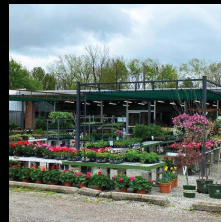

THE FOREST FLOWER



SADDLEBROOK
GOLF CLUB



GO APE TREETOP
ADVENTURE COURSE

SITE PLAN



CONTACT

BRIGHTPOINT REAL ESTATE
9450 N MERIDIAN ST. SUITE 200
INDIANAPOLIS, IN 46260

WWW.BRIGHTPOINTREALESTATE.COM

COOPER LAIKIN | MANAGING BROKER
317.989.6444
CLAIKIN@BRIGHTPOINTRE.COM

EVAN KROOT | BROKER
317.625.4377
EKROOT@BRIGHTPOINTRE.COM

B|P